

BRATISLAVA, SLOVAKIA

HOTEL RECOMMENDATIONS

Hotel Saffron, Radlinského 27, 81107 Bratislava, www.hotelsaffron.sk

Radisson Blue Carlton, Hviezdoslavovo námestie 3, 81102 Bratislava, www.carlton.sk

Hotel Devín, Riečna 162, 81102 Bratislava, www.hoteldevin.sk

Hotel Avance, Medená 9, 81102 Bratislava, <https://hotelavance.sk>

Sheraton Bratislava, Pribinova 12, 81109 Bratislava, www.sheratonbratislava.sk

HOW TO GET TO BRATISLAVA

You can arrive to Bratislava by plane, train, bus, car or boat.

By plane

BRATISLAVA AIRPORT (BTS), www.bts.aero

There are direct flights to a number of destinations in Europe and a number of airlines operate their direct routes to Bratislava. Bratislava airport can be reached from the city centre in 15–20 minutes.

VIENNA-SCHWECHAT (VIE) AIRPORT, www.viennaairport.com

The airport at Vienna-Schwechat is only 40 kilometres west of Bratislava and Slovaks mainly use it for long-haul flights. It is one of the main gateways to Slovakia. Buses to Bratislava depart at 30 to 60-minute intervals. Coaches between Bratislava and Vienna run at one-hour intervals by eurolines.sk, regiojet.com, flixbus.com

By train

Official website: www.zssk.sk and www.regiojet.com <https://oebb.at/> <https://bahn.de/>

Bratislava connects to the main lines from Prague, Budapest, Vienna and various regions in Slovakia. Bratislava has two railway stations – the Main Station and Petržalka. The Main Station is well connected to the rest of the city via trams, buses or trolleybuses and you can get to the Old Town on foot in only 15 minutes.

Bratislava is situated at the intersection of several important motorways. The distance to Prague is 330 km, Budapest 200 km and Vienna 65 km. If you are bringing your own car, you need to display a valid motorway tax sticker, available at borders or petrol stations. The minimum validity period is ten days (costs 12€) and can be issued online at <https://eznamka.sk/en>.

By bus

Official website: www.slovaklines.sk, private companies: www.eurolines.sk, www.regiojet.com, www.flixbus.com

Bratislava is also conveniently connected with many European cities via a network of bus lines. It has frequent service to the surrounding areas and also to other regions in Slovakia. Buses arrive and depart from Mlynské Nivy bus station. For more detailed information on how to enter the bus station Bratislava Nivy Centre, please read more detailed guideline prepared.

By boat

Official website: www.floratour.sk, www.lod.sk

Due to its position on the river Danube, Bratislava has regular connections by boat with Vienna. The centre of Vienna (Schwedenplatz) is connected with Bratislava by a fast catamaran Twin City Liner and another fast hydrofoil, which is berthed at Vienna Handelskai.

For more detailed information on arrival to Bratislava, please visit following website: <https://www.visitbratislava.com/your-visit/arrival/>

Public transport in Bratislava

The public transportation system consists of buses, trolley buses and trams which operate from early morning (around 4am) and end around midnight. The tickets must be purchased prior to entering a vehicle – at the ticket machines available at most of the stops, newspapers kiosks or special public transportation shops. You can also purchase a ticket by sending a blank text message (to number 1140 for 40 minutes ticket, to number 1100 for 70 minutes ticket) or by using a mobile app. Note: most foreign cellular connection providers will not support this service. In such case, it is necessary to purchase a regular ticket or purchase the SMS ticket from a number registered at a Slovak cellular connection provider.

After getting on the vehicle, you need to mark the ticket in a special machine which is built in each bus, trolley bus and tram – otherwise, if you are caught, you can get a fine of 50 €. The same goes for the text message ticket – you need to have a return sms prior to entering the vehicle.

For more detailed information on the public transport in Bratislava, including fares, please visit following website: <https://imhd.sk/ba/doc/en/20709/20709>. There is a possibility to plan your journey on public transport in Bratislava by entering the names of stops here: <https://imhd.sk/ba/journey-planner>. For specific time tables of buses, trams and trolley busses, please visit this website: <https://imhd.sk/ba/schedules-timetables>.

How to get to SPECTRA CE EU at STU

Ústav manažmentu, Slovenská technická univerzita
Institute of Management, Slovak University of Technology

Address: Vazovova 5, 812 43 Bratislava

The closest public transport stop to the Institute of Management is **Blumentál** bus stop. It operates multiple bus lines (31, 39, 94) and tram lines (3, 7, 9). The Institute is a short walking distance (2 minutes walking) from there.

You will get to the Institute of Management from Vazovova Street 5. First enter the Rectorate building and then continue downstairs to the inner yard. At the end take the stairs on your left side and you'll enter the building of the Institute of Management.

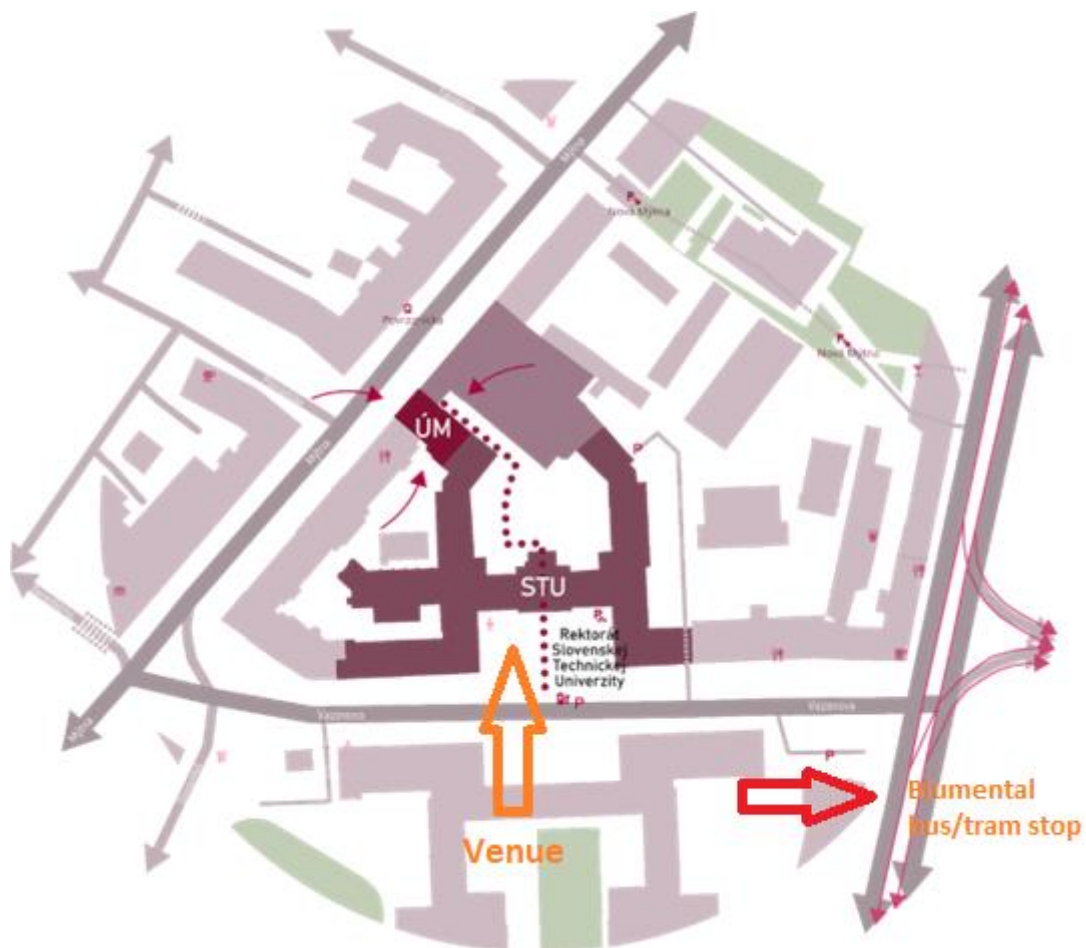

Bratislava - NIVY Bus Station

Arrival and departure guide

Nivy Centrum is a multifunctional building in Bratislava consisting of a bus station, shopping centre, marketplace and a green rooftop. The bus station is open 24 hours a day, but other parts of the Nivy centre have their own opening hours.

The entrances to the building are situated as follows:

Entrance on Páričkova Street

Main entrance on Mlynské Nivy Boulevard

Entrance from the Nivy Tower side on Svätoplukova Street – **Open 24/7**

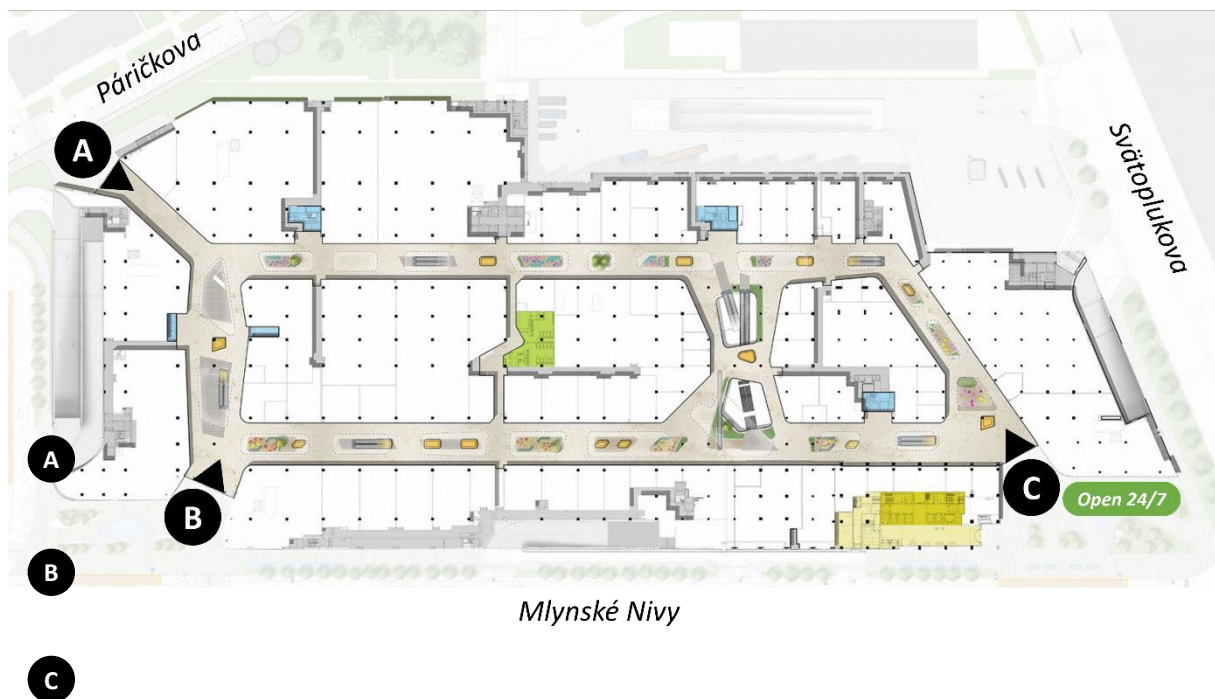

1. Arriving by bus to the bus station

You will arrive to the bus station located at floor -1. To get outside of the building, you will need to head towards the “Willkommen, Vitajte, Welcome” sign and take the escalator to the floor 0 (shopping centre).

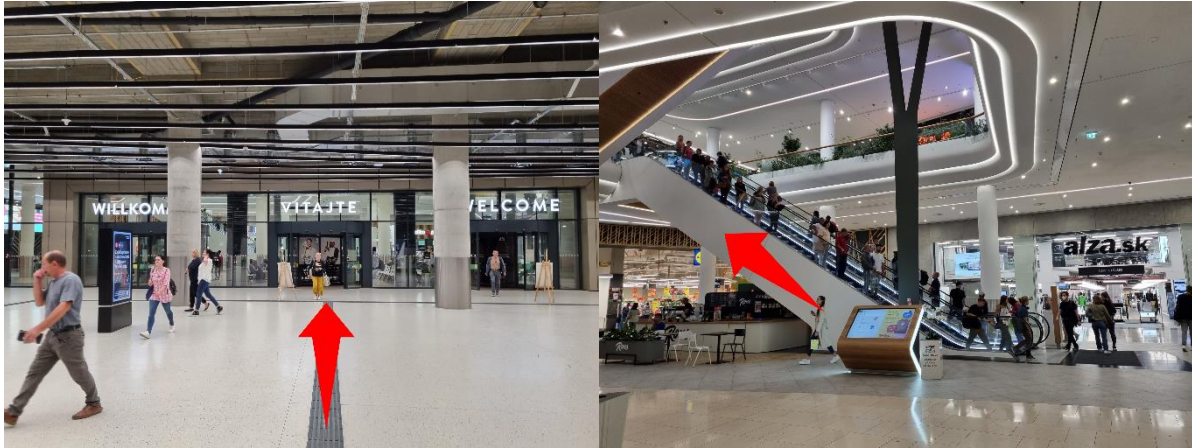

Depending on which exit from the building you need to use, you will then either turn left for exit A and exit B or turn right for exit C. There are bus stops near each of the exits. Google maps will guide you to the best bus stop for you depending on your destination.

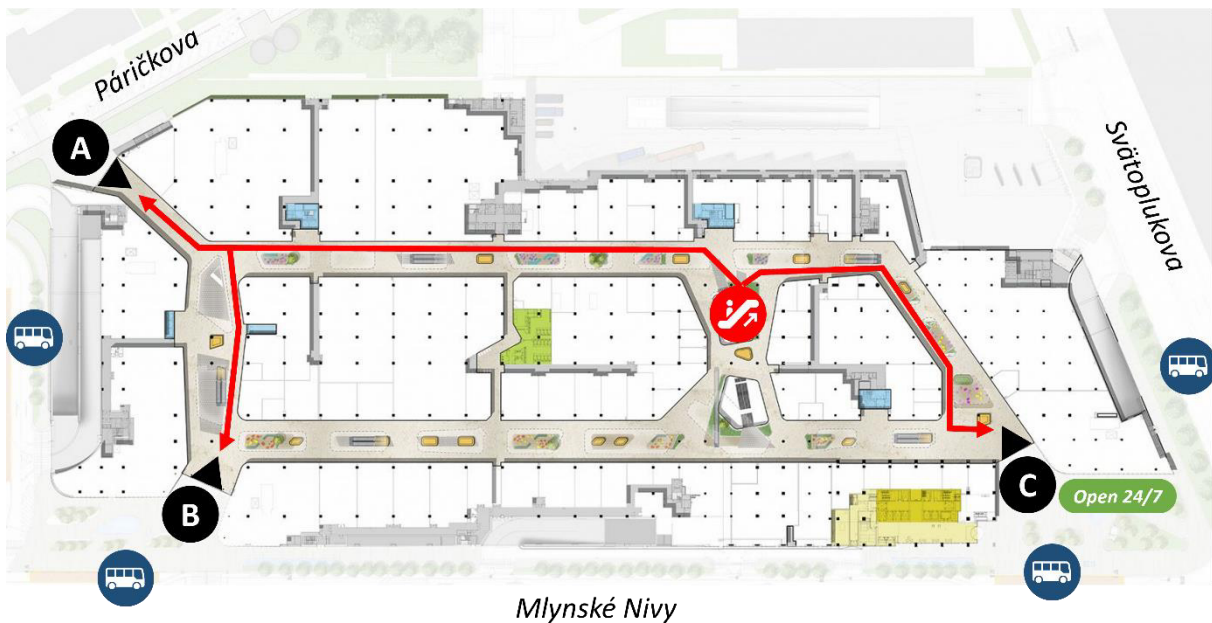

2. Departing by bus from the bus station

As the orientation within the building might be challenging, we recommend arriving to the Nivy centre at least 20 minutes before your scheduled bus departure. There is some little navigation system on the floor as well as higher above.



You can use all 3 entrances (A, B or C) to get to the bus station. You will enter the building of the Nivy Centre at the floor 0 (shopping centre) and you will need to get to floor -1 to get to the bus station.

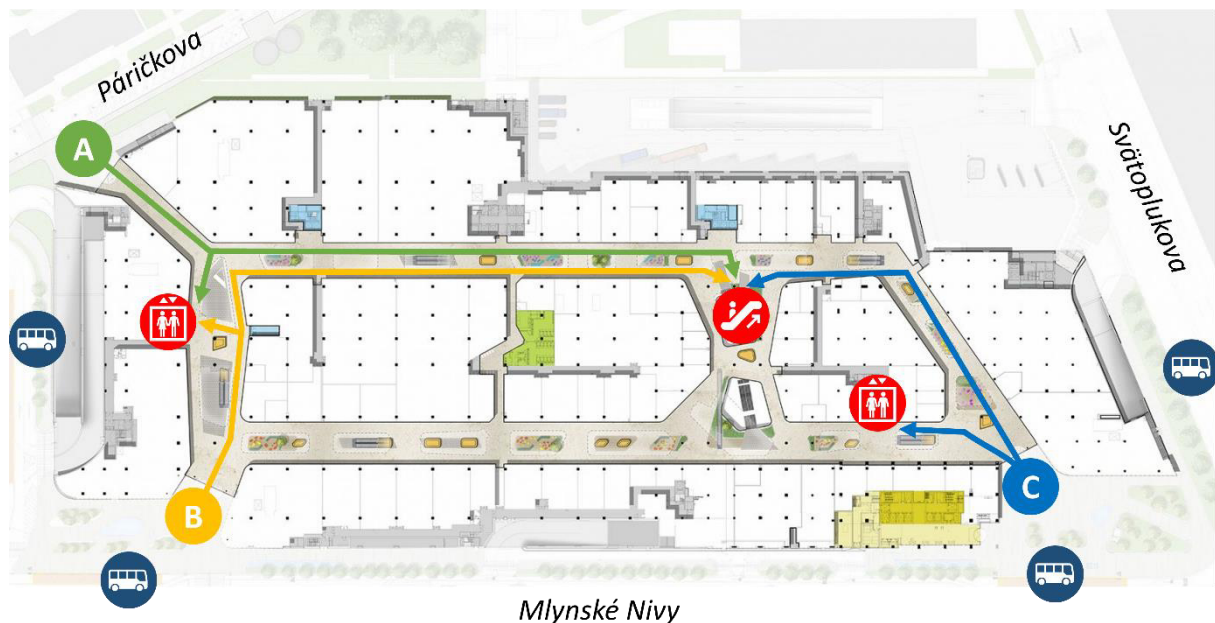

Entrance **A**

If you enter the building from Páříčkova street (entrance A), the fastest way to get to the bus station is to turn right and take the elevator to floor -1. Another option is to turn left and continue to the escalator which will take you to floor -1 (bus station).

Entrance **B**

If you enter the building from Mlynské Nivy street, the fastest way to get to the bus station is to turn left and take the elevator on your left to floor -1. Another option is to go straight forward and then turn right and continue to the escalator which will take you to floor -1 (bus station).

Entrance **C**

If you enter the building from Mlynské Nivy street, the fastest way to get to the bus station is to turn left and take the elevator to floor -1. Another option is to go straight forward and turn left at the end, then continue to the escalator which will take you to floor -1 (bus station).

The platform from which your bus will be departing can be found either:

- a) on your bus ticket,
- b) at the online search: <https://nivy.com/en/buses/search-results> , or
- c) you can find a board with the departing busses above each platform.



The general departure boards do not display departures of external companies such as FlixBus or Regiojet.

